



USER MANUAL 1006258-01

Worcester Self Closing Gate

PRODUCT CODES:

1006102-01 - Bundle 1-Way

1006239-01 - Bundle 2-Way

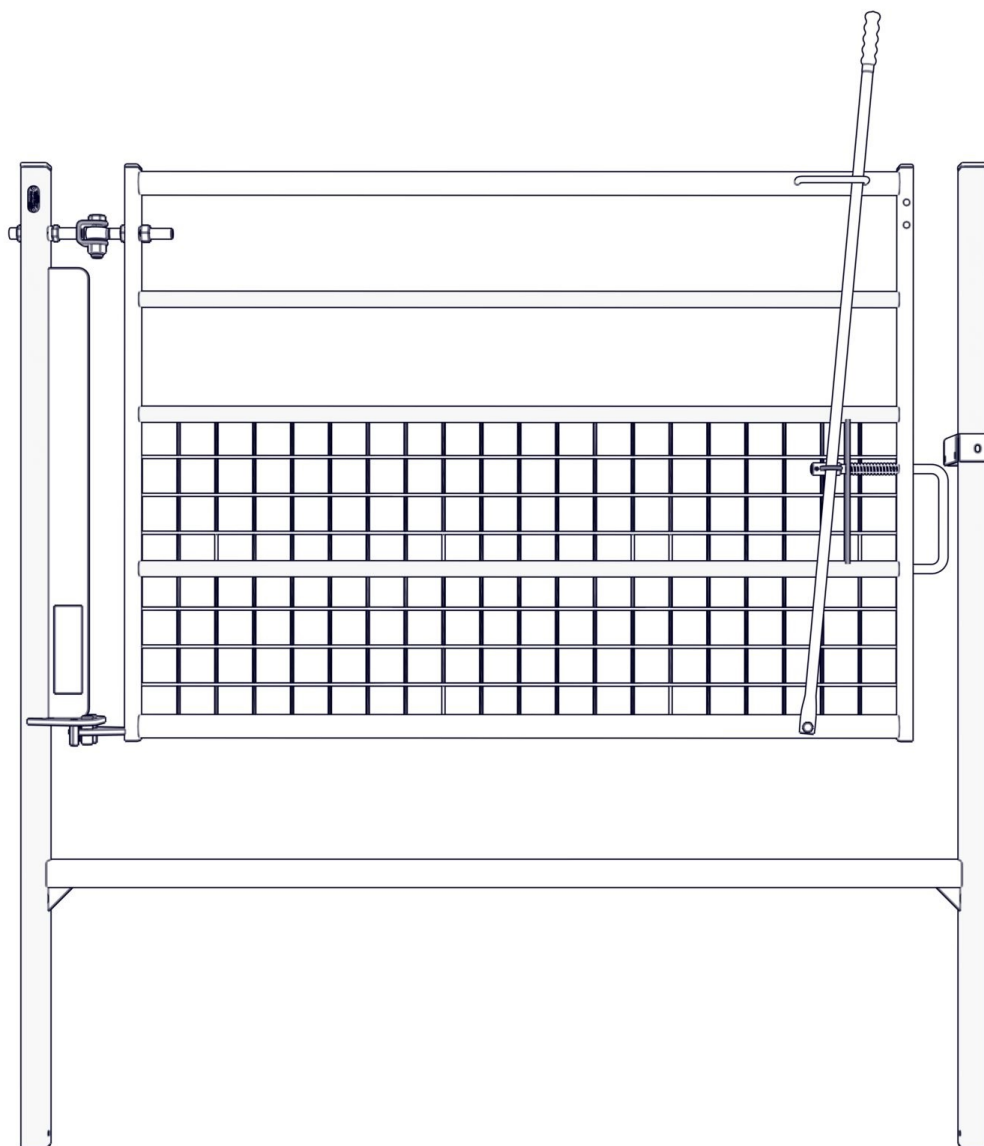

1-WAY LATCH FITTED DETAIL

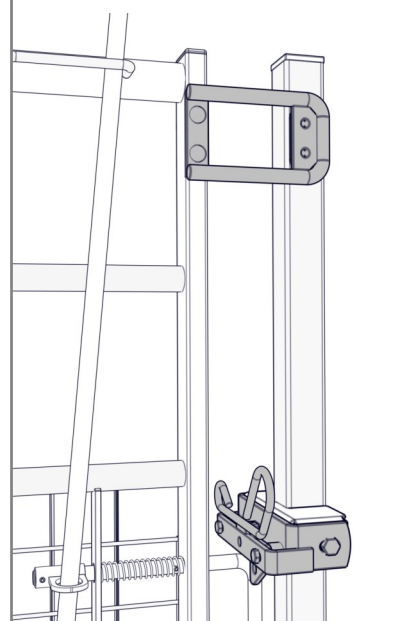

2-WAY LATCH FITTED DETAIL

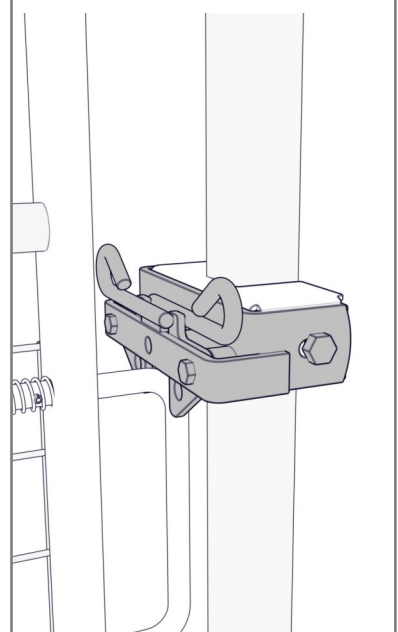

GATE FRAME SUPPLIED WITHOUT THE LATCH FITTED
AS SHOWN ON ABOVE IMAGE- CUSTOMER WILL HAVE TO ASSEMBLE EITHER THE
1-WAY OR 2-WAY ONTO THE GENERIC GATE.



About Worcester Self Closing Gate In Frame

CONTENTS

Parts For Assembly - 1-Way	Page 3
Parts For Assembly - 2-Way	Page 4
Gate Installation Into Ground	Page 5
Setting Bridle Handle To Operate Mode	Page 6
Adjust Controlled Speed Hinge System	Page 6
How To Assemble 1-Way Latch	Page 7
How To Assemble 2-Way Latch	Page 8

TECHNICAL DATA

Item Number: 1006102-01 1-WAY BUNDLE OR,
1006239-01 2-WAY BUNDLE

Dimensions: 1920 x 1966 (overall frame)

Weight: 75 Kg (approx.)

INTENDED USE

The Worcester Bridle Gate is a self-closing gate system featuring a galvanized steel mesh gate with built-in H-frame posts. The design also incorporates the Prosafe self-closing mechanism.

Made from steel, all of our bridle gates are designed to close automatically through an offset hinge arrangement, ensuring enhanced reliability and minimal maintenance. This gate is built to meet specific safety, quality, or performance standards as defined by the British Standards Institution - ref. **BS 5709:2018**

RECOMMENDED MAINTENANCE

1. Inspection

- ☐ Frame and Structure: Check the frame for any rust, corrosion, or damage.
- ☐ Hinges: Inspect the hinges to make sure they're not worn out, bent, or rusty.
- ☐ Locks and Latches: Make sure locks and latches are functioning smoothly and are not rusted or jammed.
- ☐ Post/Support Structure: Ensure the post or support is stable and doesn't have cracks, signs of movement, or any issues.

2. Cleaning

- ☐ Debris Removal: Clear away any debris, dirt, leaves, or anything else that may block the movement of the gate.
- ☐ Washing: Use a mild detergent solution to wash the gate. For metal gates, consider using a rust inhibitor to prevent corrosion.
- ☐ Lubrication: Lubricate hinges, latches, and any moving parts regularly with an appropriate lubricant like silicone or grease to reduce friction and wear.

3. Gate Alignment

- ☐ Ensure the gate is still properly aligned with its post and opens/closes without obstruction or strain. If it's sagging or misaligned, you might need to adjust the hinges or the mounting system.

4. Hydraulic unit checks

- ☐ Check that the gate close times are appropriate according to British Standards and adjust if necessary.
- ☐ Prolonged periods of inactivity, especially in harsh or extreme environmental conditions, may lead to deterioration or malfunction of the equipment. It is strongly recommended that the equipment be regularly inspected and serviced.

PRECAUTIONS

- ☐ Not suitable for use in a strained fence line.
- ☐ Avoid . and damp ground.
- ☐ Remove overhanging branches or exposed roots.
- ☐ Consider the existing fence line or boundary the may impact the siting of the product.

SAFETY INFORMATION

PLEASE TAKE NOTE OF THE FOLLOWING SAFETY PRECAUTIONS BEFORE USE FOR THE WELLBEING OF ALL ANIMALS AND PERSONNEL. ANY HARM OR INJURY WHICH OCCURS FROM THE LACK OF COMPLIANCE WITH THESE HEALTH AND SAFETY MEASURES WILL BE THE RESPONSIBILITY OF THE OPERATOR.

- ☐ **IMPORTANT!** Read these instructions carefully before use and keep them for future reference. The safety of your animals may be affected if you do not follow these instructions in this manual.
- ☐ Situate this product on a level, solid surface.
- ☐ **WARNING!** Be careful with hands, fingers and limbs when operating.
- ☐ Personal protection may be required for some stages of installation, and/or operation.
- ☐ **CAUTION!** When handling heavy equipment, some stages of installation may require at least two people.
- ☐ **DO NOT** lean on or exert undue pressure on the product.
- ☐ **CAUTION!** Check posture when lifting/manoeuvring the equipment or associated parts.
- ☐ **ALWAYS** Check the product for damage before each use.

If you have any questions or comments regarding the product, we will be glad to hear them either through our website or by contacting our sales team,

CONTACT

Centrewire Ltd
Mossfield Road
Adderley Green
Stoke-on-Trent
England
ST3 5BW

T: +44 (0)1782 339348
E: sales@centrewire.com

Parts For Assembly

Worcester 1600 Leaf Gate Bundle 1-Way – Parts List

Product Name: Worcester 1600 Leaf Gate

Version: Bundle 1-Way

Date: 03/04/2025

① Gate Frame

Part Number: 1003242

Description:

WORCESTER SELF CLOSING GATE IN FRAME

Quantity: 1

② Gate Latch

Part Number: 1005541

Description:

BRIDLE GATE 1-WAY CONVERSION KIT

Quantity: 1

Assembly required

- Bridle handle to be re-positioned to operating mode.
- 1-Way latch to be assembled onto the gate by the customer,

Assembly instructions for the above to follow ,

Tools Required for Assembly:

1. Wrench/Socket Set
2. Pliers

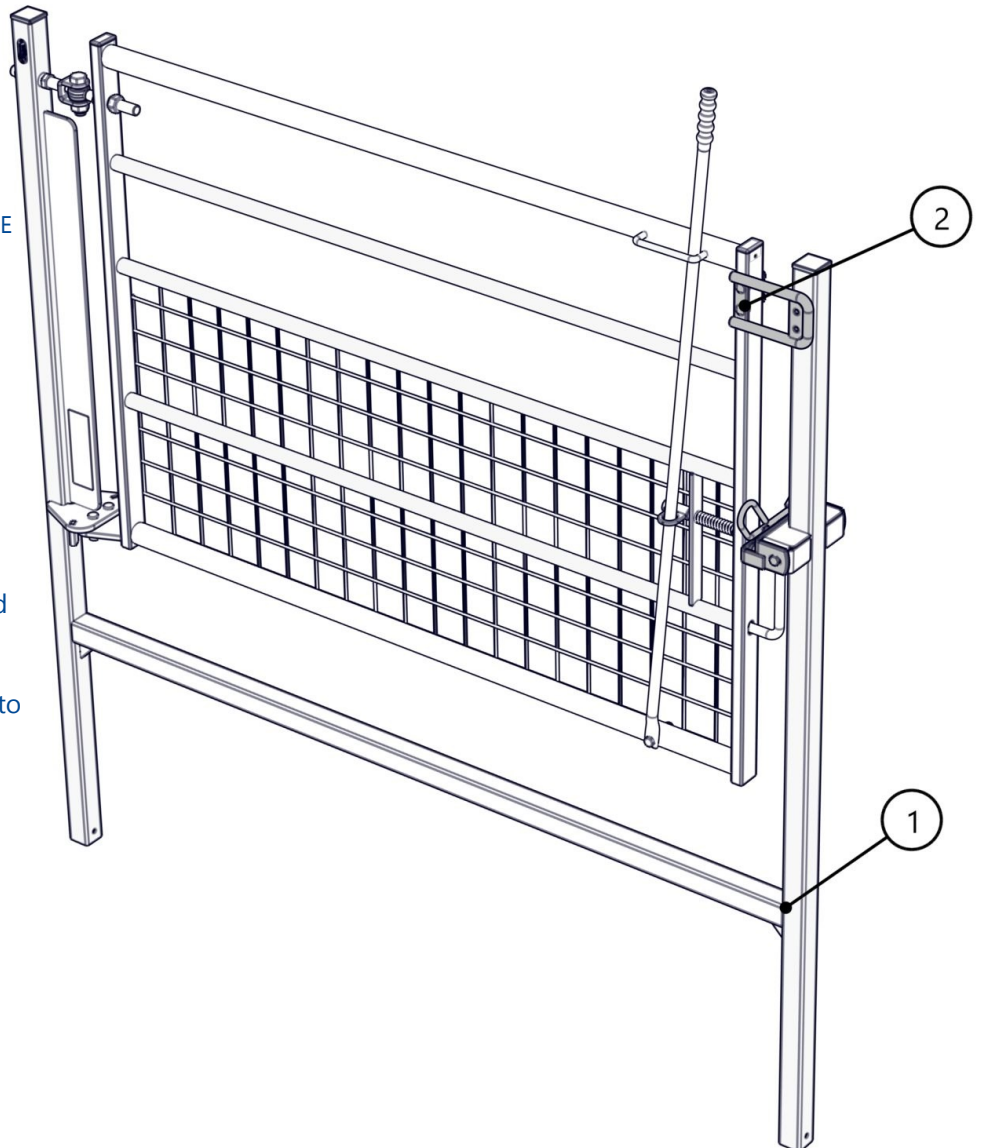

1-WAY LATCH KIT - PARTS TO BE ASSEMBLED

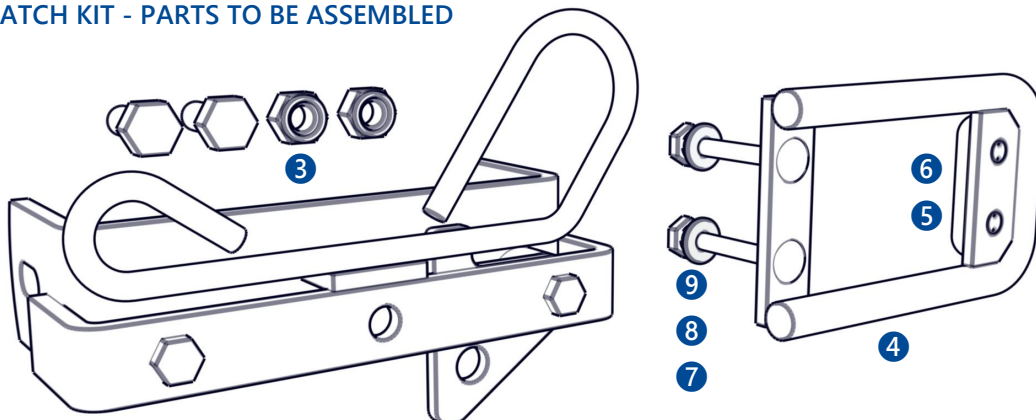

③ 1No. - 1-WAY LATCH KIT T/S STEEL POST (ASSEMBLED)

④ 1No. - BOLT ON ONE WAY STOP

⑤ 1No. - RUBBER BUMP STOP

⑥ 2No. - M6X12 CSK SNAKE EYE SECUR/SCREW

⑦ 2No. - M8 X 65 CUP SQ BOLT

⑧ 2No. - M8 PERMACONE NUT

⑨ 2No. - M8 WASHER

Worcester 1600 Leaf Gate Bundle 2-Way – Parts List

Product Name: Worcester 1600 Leaf Gate

Version: Bundle 2-Way

Date: 03/04/2025

① Gate Frame

Part Number: 1003242

Description:

WORCESTER SELF CLOSING GATE IN FRAME

Quantity: 1

② Gate Latch

Part Number: 1000902

Description:

2 WAY CATCH T/S STEEL POSTS

Quantity: 1

Assembly required

- Bridle handle to be re-positioned to operating mode.
- 2-Way latch to be assembled onto the gate by the customer,

Assembly instructions for the above to follow ,

Tools Required for Assembly:

1. Wrench/Socket Set
2. Pliers

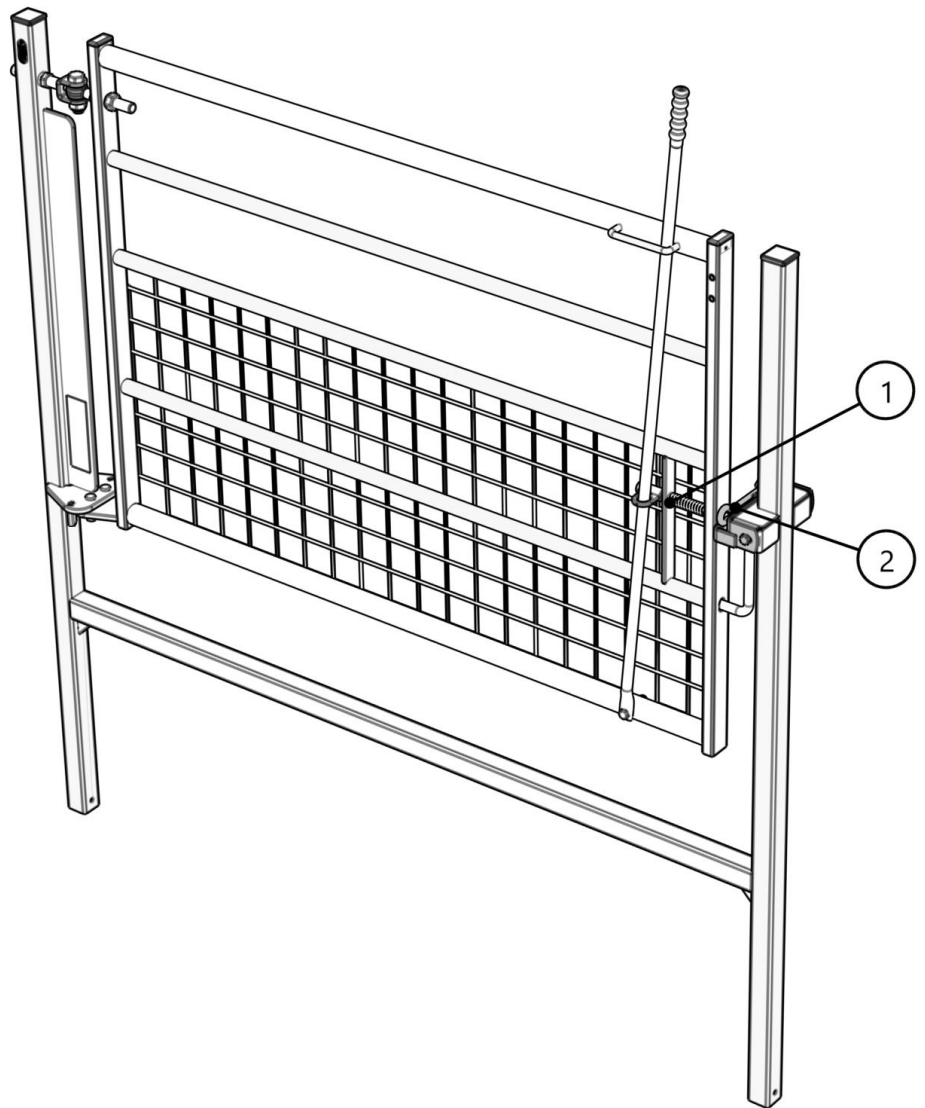

2-WAY LATCH KIT - PARTS TO BE ASSEMBLED

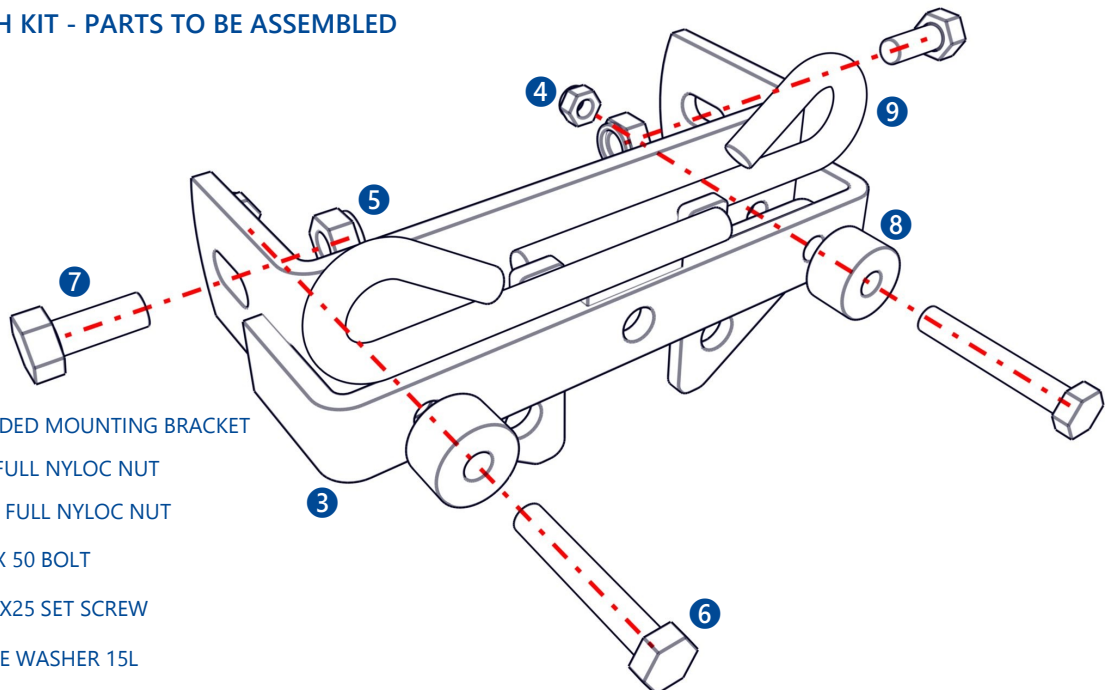

- ③ 1No. - WELDED MOUNTING BRACKET
- ④ 2No. - M8 FULL NYLOC NUT
- ⑤ 2No. - M10 FULL NYLOC NUT
- ⑥ 2No. - M8 X 50 BOLT
- ⑦ 2No. - M10X25 SET SCREW
- ⑧ 2No. - HDPE WASHER 15L
- ⑨ 2No. - 2-WAY FORMED PAWL

Gate Installation Into Ground

Gate Installation into Ground: Step-by-Step Guide

Materials Needed:

- Gate H frame + gate (pre-assembled)
- Concrete mix (optional, for extra stability)
- Level
- Measuring tape
- Shovel
- Gravel (optional)

Step 1: Plan the Gate Placement

Measure the location where you want to install the gate.

Use a **measuring tape** to mark the overall length and width of the H frame. Mark the ground at these locations for accuracy.

Typical Worcester Gate Detail

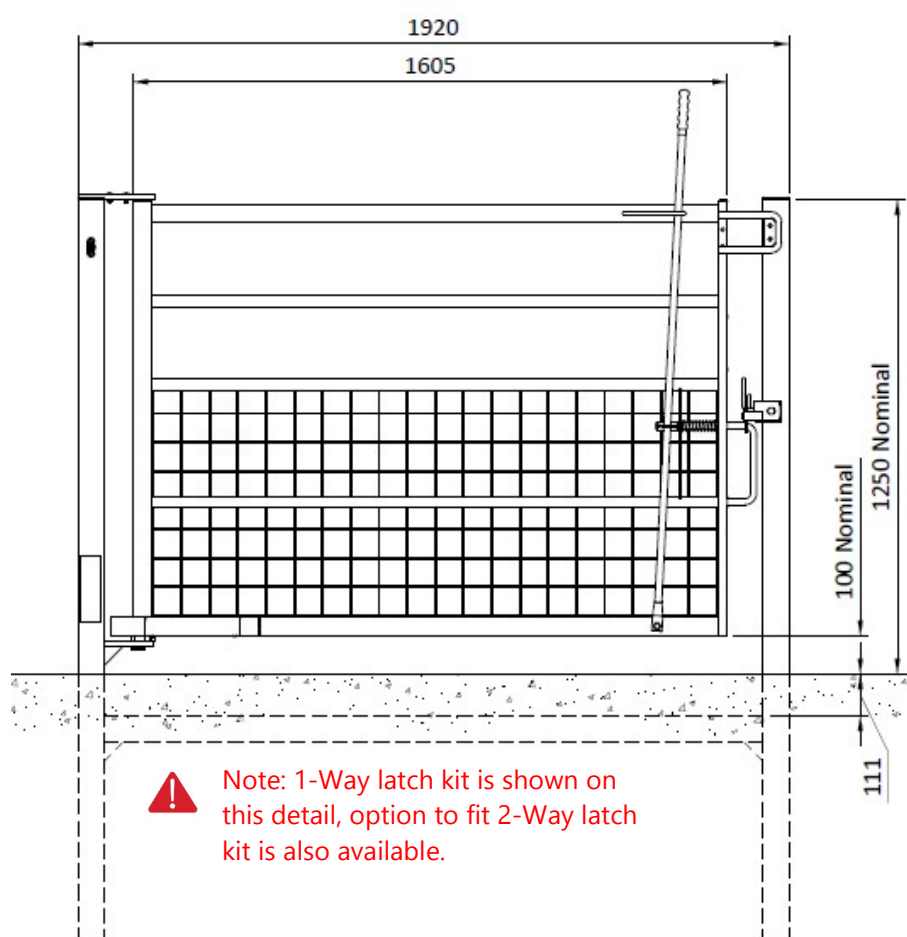

Step 2: Dig Holes for the Gate Posts

Use a **shovel** to dig holes for the gate posts. The depth should be enough to allow the cross bar of the H frame to be **75 - 120mm below ground level** and for the **gate to be approximately 100mm above ground level**. Ensure the hole width is wide enough to fit the post and concrete (if you're using it).

Step 3: Position and Level the Posts

Place the gate posts into the holes. The post should be positioned vertically and to centre of the hole.

Use a **level** to ensure the frame is plumb (straight) and adjust as necessary.

If desired, place a small amount of **gravel** at the bottom of the hole for drainage.

Step 4: Secure the Posts

If using concrete, **mix the concrete** according to the manufacturer's instructions.

Pour the concrete around the posts in the hole until it's filled. Make sure the posts remain straight and level as the concrete sets.

If you are not using concrete, use **dirt** to backfill the hole, packing it tightly to secure the post in place.

Step 5: Check Gate Alignment and Operation

Ensure the gate swings easily, without any obstruction. Check that the gate close times are appropriate according to British Standards and adjust if necessary. In addition, check H-frame posts are vertical.

How To Set Bridle Handle To Operate Mode

Step-by-Step Instructions

Tools Needed:

- Wrench or socket set
- Pliers

Hardware Included:

- Bridle handle, bolts, washers and nuts are all included in the gate assembly. For security and risk of damage in transport the bridle handle is assembled down (inline with H frame cross bar)

Step 1: Disassemble Bridle Handle

Use the appropriate wrench to loosen and remove the bolts holding the handle in place. If the handle has been secured to the gate frame using a cable tie, make sure to remove it. Keep the bolts and any other small parts in a safe location for reattachment later (if needed)

Step 2: Reattach the Handle

Align the gate handle with the drilled holes.

Ensure the bridle handle is inserted through both the top rail handle guide and the sliding D loop before fastening as per detail **a**. Insert the bolt through the handle's holes, then place a washer and nut on the other side of the gate. Tighten the nut with a wrench or socket set to secure the handle.

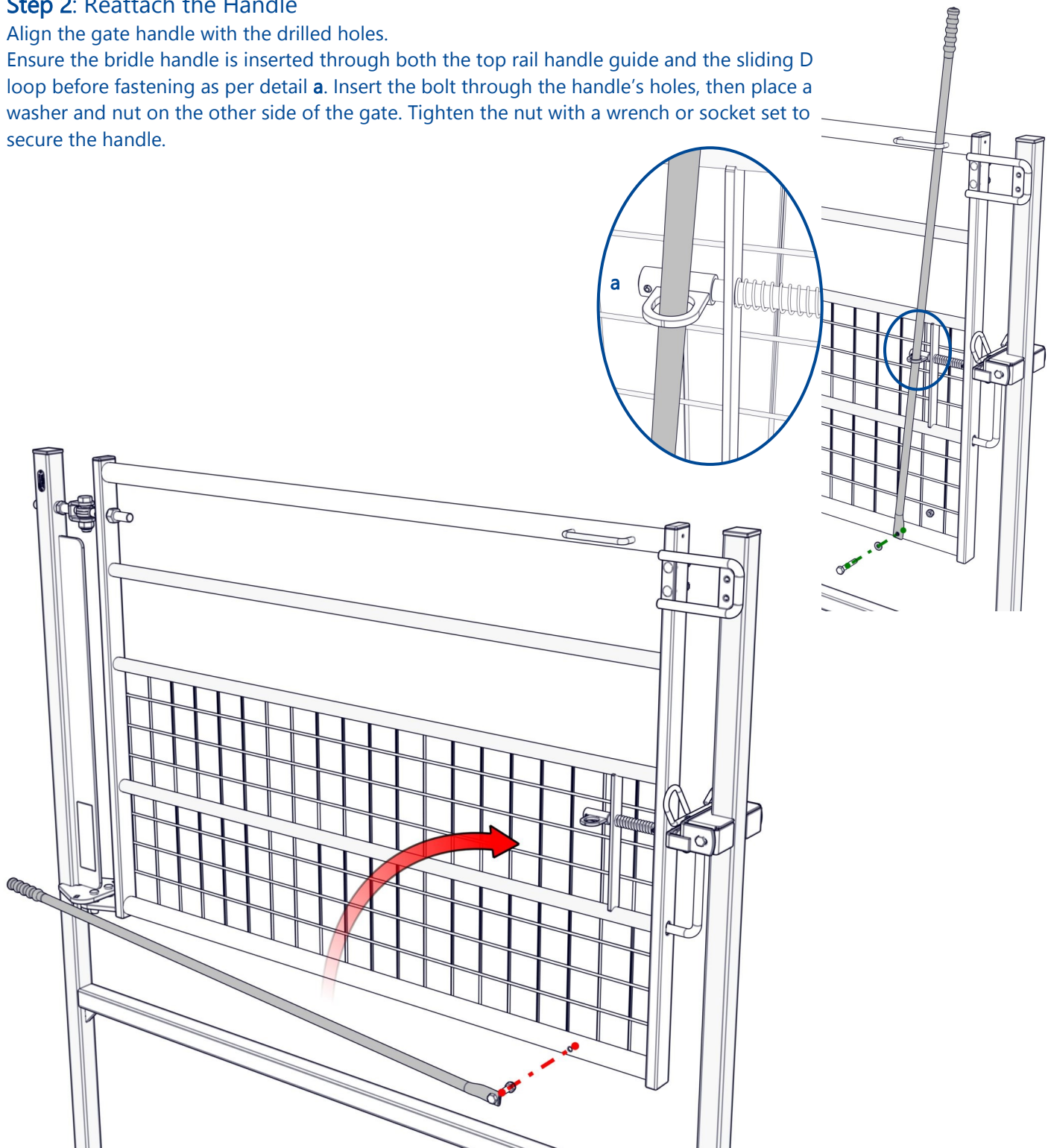

How To Adjust Closing Speed

Assembly Instructions:

1. **Step 1:** Locate speed adjustment screws - on underside of the hydraulic closing system.
2. **Step 2:** Turn both screws in an anti-clockwise direction to close off both valves - this will pause the gate opening or closing.
3. **Step 3:** Turn both screws approx. $1\frac{1}{4}$ to $1\frac{3}{4}$ turns in a clockwise direction. This should give an even speed throughout with an approx. overall closing time of 5 seconds.
4. **Step 4:** Fine adjustment can be made by turning the screws clockwise (faster) or anti-clockwise (slower) to give the desired closing.

ONLY a $\frac{1}{4}$ turn can make a large difference to the speed of the gate.

DO NOT turn the screws more than 3 turns from the closed position. If in doubt, close off valves and start again. If the screw is turned past this point, oil loss will result causing the mechanism to fail, this invalidating all warranty.

Tools Required for Assembly:

1. Allen keys

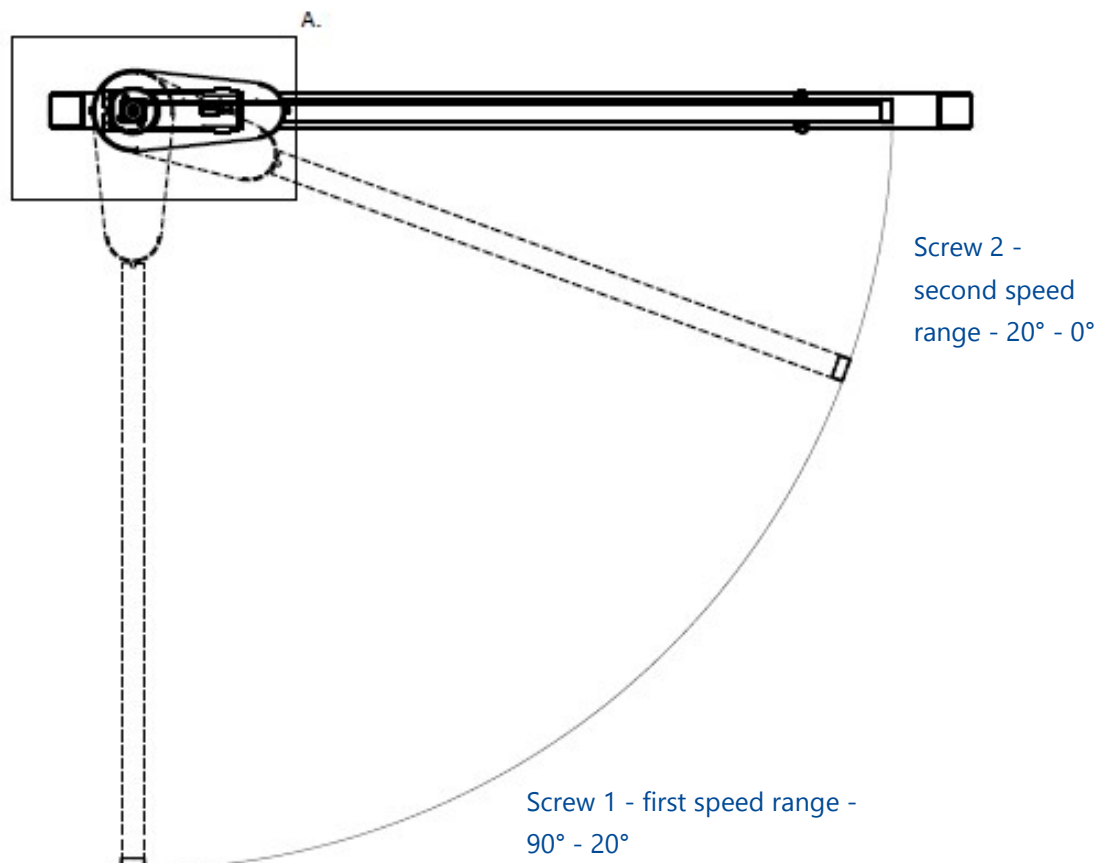
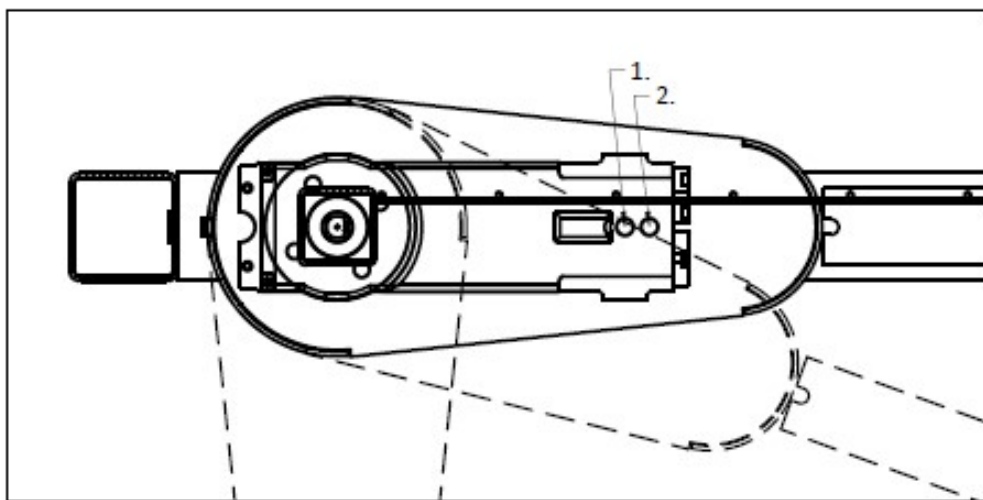

How To Assemble 1-Way Latch

Assembly Instructions:

1. **Step 1a:** Remove blanking plugs (x4) from gate frame (top of slam stile).

Step 1b: Fit the rubber bump stop to the 1-Way stop using snake eye driver to fasten screws.

AS FITTED:

2. **Step 2:** Secure the 1-Way stop on the desired side of the gate - using cup square bolts, washes and permacones.
3. **Step 3:** Mount the 1-Way latch onto the steel post and secure - using M10 and M8 bolts and nuts - ENSURE the 1-Way loop is on the same side as the 1-way stop. Both should be positioned on the desired direction for opening.

Tools Required for Assembly:

1. Wrench/Socket Set
2. Snake Eye Driver
3. Pliers

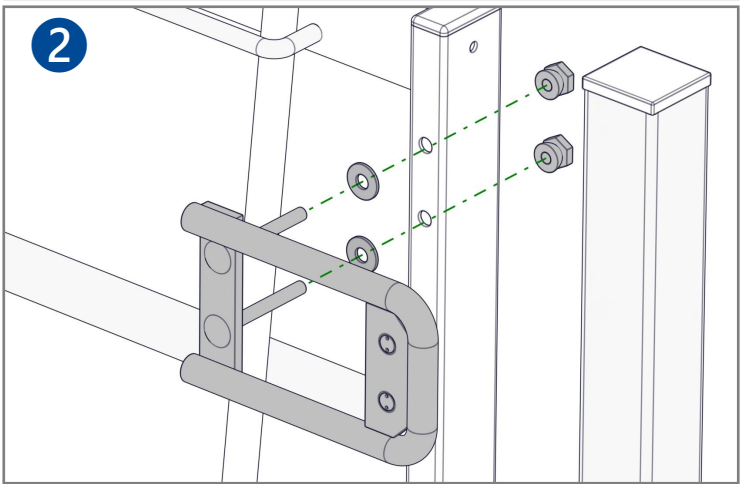
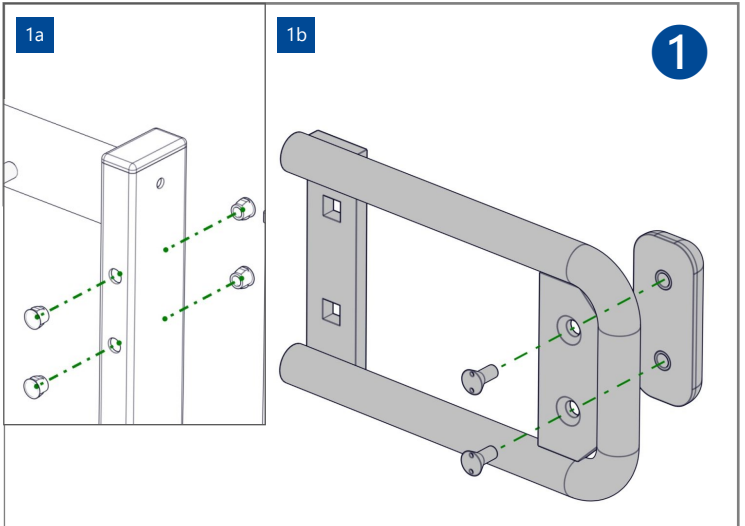

1-WAY LATCH KIT EXPLODED

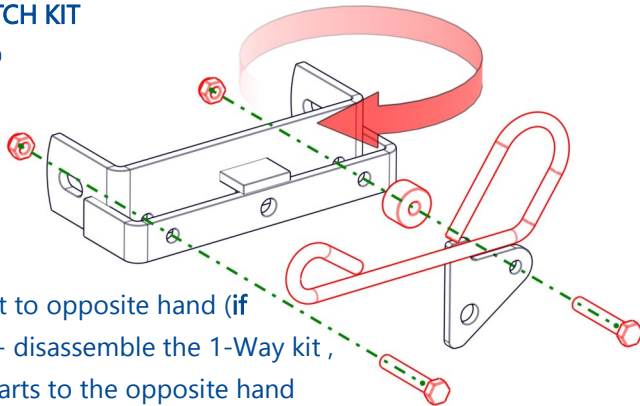

To convert to opposite hand (if required) - disassemble the 1-Way kit, reorient parts to the opposite hand configuration (flip parts highlighted red 180°) and reattach components.

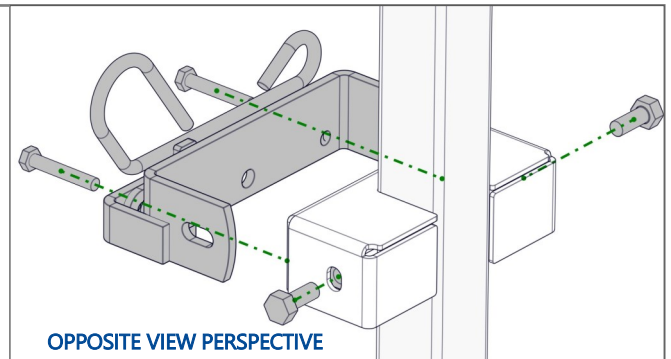

3

SECTION: 1-WAY LATCH DETAIL

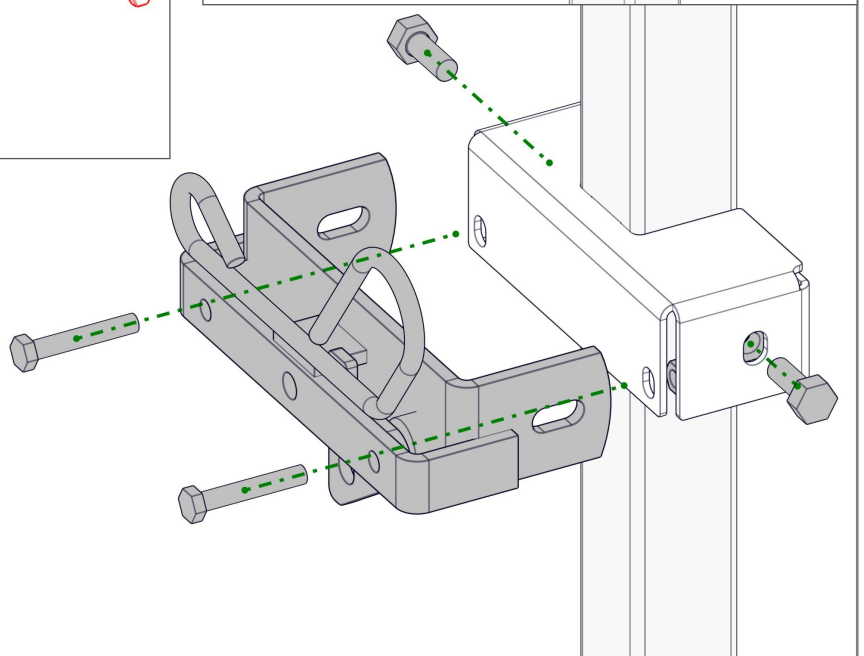
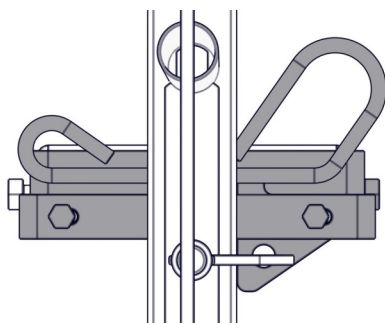

How To Assemble 2-Way Latch

Assembly Instructions:

1. **Step 1:** Detach 2No. M10 and 2No. M8 bolts and nuts as supplied fitted to the 2-Way Latch kit. - Keep the bolts in a safe location for reattachment later.
2. **Step 2:** Mount the 2-Way latch on the steel post.
3. **Step 3:** Secure the 2-Way latch to the post - using M10 and M8 bolts and nuts.

Tools Required for Assembly:

1. Wrench/Socket Set
2. Pliers

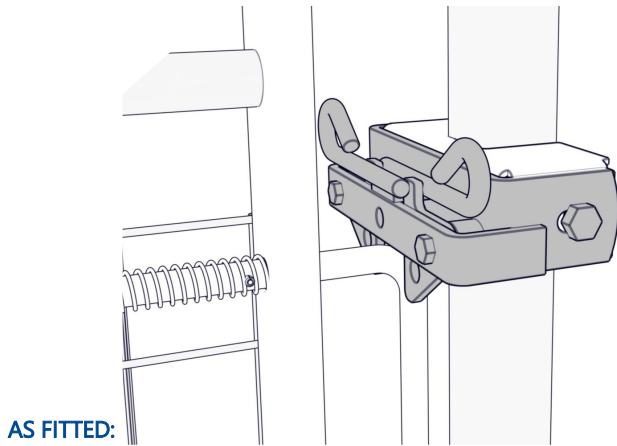

1

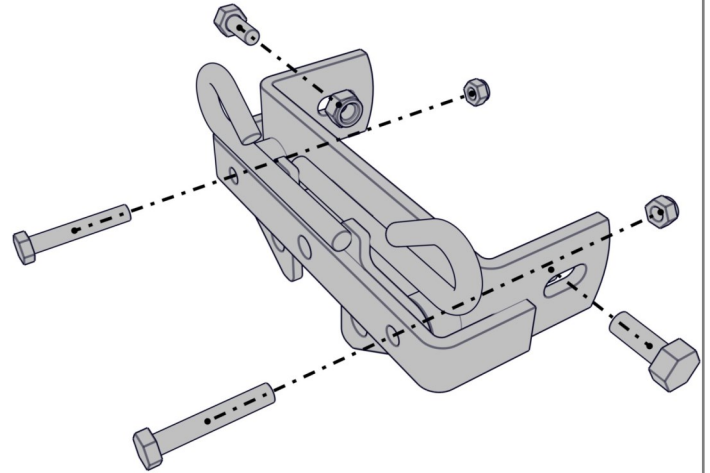

2

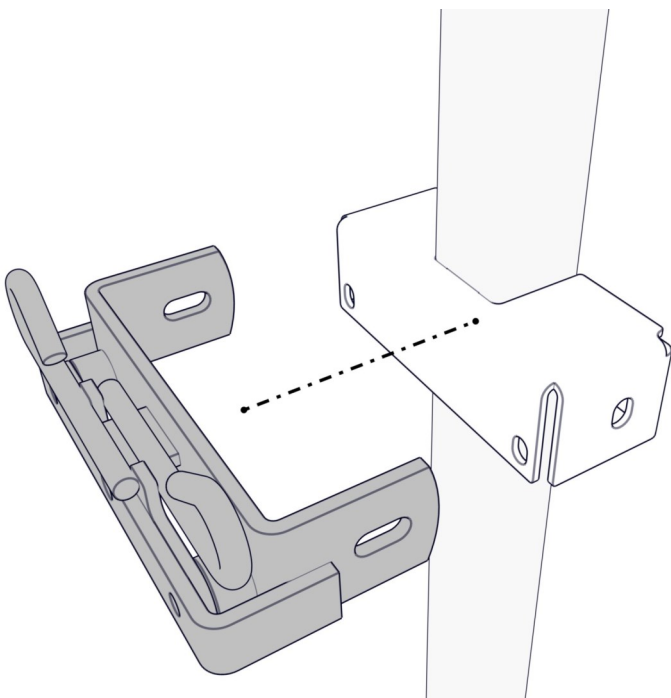

3

